

TOW BAR A-088

Audi A6 4D (Quattro) (04/2004 - r.)
Audi A6 Avant (Quattro) (03/2005- r.)
FITTING AND OPERATION MANUAL.

Cat. No.A-088

DESTINATION

Tow bar **A-088** for a **Audi A6 4D/Avant (Quattro)** is designed for towing a trailer. This ball hook has a current certification of approval authorizing the product with **e20** certification sign.

FITTING CONDITIONS

Tow bar **A-088** can be used and operated in a car with proper technical conditions of body elements. Those parts cannot be mechanically damaged. The ball hook has to be installed and operated in a car according to this instruction. All bolts and nuts in ball hook have to be screwed down with proper torque (Mo). Torque values are given below:

M8	-	25 (Nm)	M12	-	85 (Nm)
M10	-	50 (Nm)	M16	-	200 (Nm)

OPERATION CONDITIONS

The tow bar **A-088** has a rating plate describing correct and safe loads of the hook:

Typ: A-088 A50-X e20 0283-00 D = 11,0 kN S = 85 kg R = 2100 kg	The tow bar for Audi A6 4D/Avant (Quattro) Tow bar class (compressing device) Tow bar certification of approval number Theoretical related force working on a ball hook Max permissible vertical load of the hook ball Max permissible load of towing trailer
--	---

D - force is calculated using the following formula:

$$D = g \times \frac{T \times R}{T + R} \text{ kN}$$

T-technically permissible maximum mass in tonnes of the towing vehicle (also towing tractors) including, if necessary, the vertical load of a centrale axle trailer.
R-technically permissible maximum mass in tonnes of the full trailer with drawgal free to move in the vertical plane or of the semi-trailer.
g-acceleration due to gravity (assumed as 9,81 m/s²)

During operating individual elements of ball hook should be kept in a proper technical condition and protected from corrosion. The trailer must be linked with an elastic joint with proper durability (cord, chain) while towing. It is necessary to check periodically bolt joints during operating the ball hook. If screws are eased, it is necessary to screw them down.

FITTING

The tow bar **A-088** for **Audi A6 4D/Avant (Quattro)** is made up of the following elements:

1.Towbar mainframe	- 1 piece	6. Flat washer 13,0	- 2 pieces
2.Tow ball	- 1 piece	7. Spring washer 10,2	- 2 pieces
3.Electrical socket plate	- 1 piece	8. Spring washer 12,2	- 2 pieces
4.Special washer 40/ 10,5x2,5	- 6 pieces	9. Nut M10	- 2 pieces
5.Bolt M12x70	- 2 pieces	10.Nut M12	- 2 pieces

Follow the general directions in order to fit **A-088** tow bar properly:

- 1.Rear bumper cutting is **required**.
- 2.Remove a rear bumper and remove the strengthening of bumper..

16.08.2007.

Cat. No. A-088

3. Take the towbar to pieces.
4. Put (1) to the external chasis rails, next from the trunk side put the bolts in the factory-made holes, that has left after removing the bumper strengthening, with (4).
5. The farthest bolts from both sides of the back strip screw with (9), (4) and (7).
6. All bolts that has left screw with nuts in the car.
7. Put the rear bumper to the car and mark the place and size of cutting and then cut out.(size ~50x80mm).
8. Attach the rear bumper to the car.
9. Screw (2) to (1) using (5) and (6), (8) and (10), also attach (3) in the left side of (2).
10. Check if all fixing bolts and nuts are screwed hard enough.

Obeying this instruction assures correct montage and the tow bar operating in a Audi A6 4D/Avant (Quattro).

After assembling of the tow bar **A-088** you have to get entry in cars **registration book** in a quality control station.

CAUTION:

All mechanical damages of tow bar excludes its further exploitation. Damaged ball hook **cannot be repaired**. In case of braking the rules of montage or unproper usage manufacturer **do not take responsibility** for arised damages.

MONTAGE DIAGRAM:

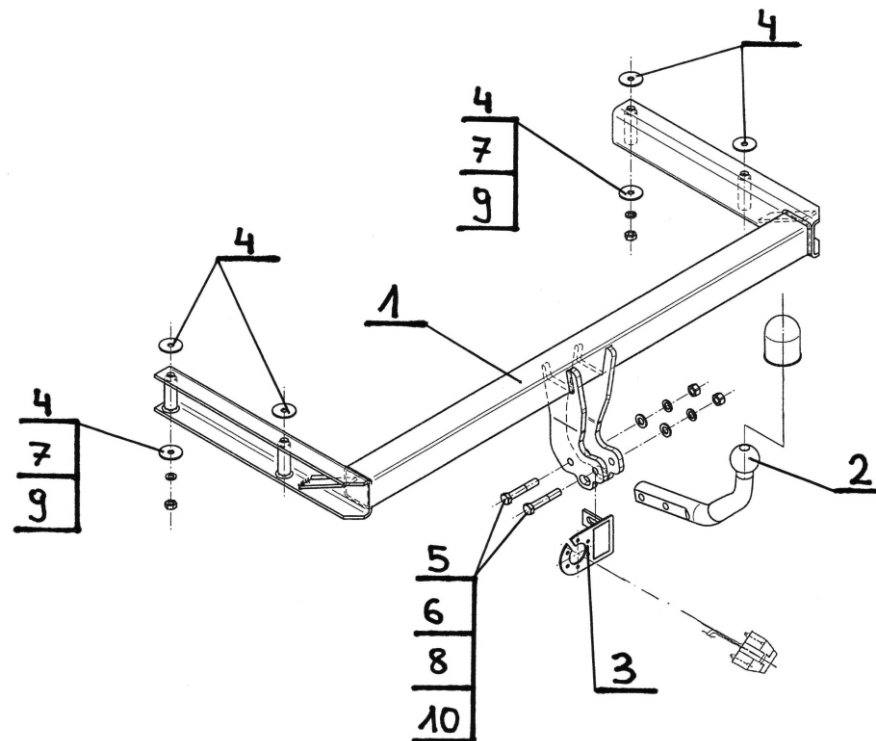

NOTE:

Bunch of wires is not included (in total price).

Cat. No. A-088